

Kirtland Health Sciences Center

Naming Opportunities



Kirtland's Partnership for Excellence Campaign

Partnering with Kirtland to Fund the Health Sciences Education & Training Center

Kirtland Community College is seeking educational partners for the construction of a new Health Sciences Education & Training Center located on Interstate 75. Your partnership will ensure the education of future employees at our medical centers and provide for better health care in all of northern Michigan. Equally important, your willingness to partner will provide training opportunities for existing health care professionals vital to maintaining quality health care.

Kirtland is also providing partnership opportunities on the Roscommon Campus to help educate much needed skilled trades professionals.

To become a Kirtland partner, please consider funding any of the naming opportunities listed in this piece in the form of a cash donation, material donation, planned gift or a pledge. Partnering with Kirtland in this venture allows you to leave a legacy, honor a loved one or demonstrate your support for the necessity of keeping education relevant, accessible and transformational. Your generous gift represents a commitment to meeting the needs of our students and our communities for years to come. Kirtland partners will have their name engraved on a memorial plaque and placed in a suitable location.

For more information, contact a Foundation staff member who can answer your questions about how you can become a Kirtland partner and provide advice on the size or nature of the contribution you may choose to make.

In summary, your support of Kirtland's Partnership for Excellence Campaign will provide our children and grandchildren the opportunities for an accessible, state-of-the-art health care education, preparing them for quality jobs in the health care industry. And no matter how long you've resided in this area as a full- or part-time resident, weekender or as a visitor for a few weeks each summer, maintaining quality health care is crucial. Everyone should have a vested interest in it because you never know when you'll need it.

We thank you in advance for supporting Kirtland's Partnership for Excellence Campaign with a named area designation that signifies your commitment and belief in the importance of education now and for years to come.

Thank you,

William E. Curnalia, Chairman
Kirtland Community College Foundation

Pledge Opportunities Available

Partnering with Kirtland

Tom Quinn, President
(989) 275-5000 EXT 221

Investing in the Future

Lynne Ruden, Executive Director Kirtland Foundation
(989) 275-5000 EXT 446

Lower Level

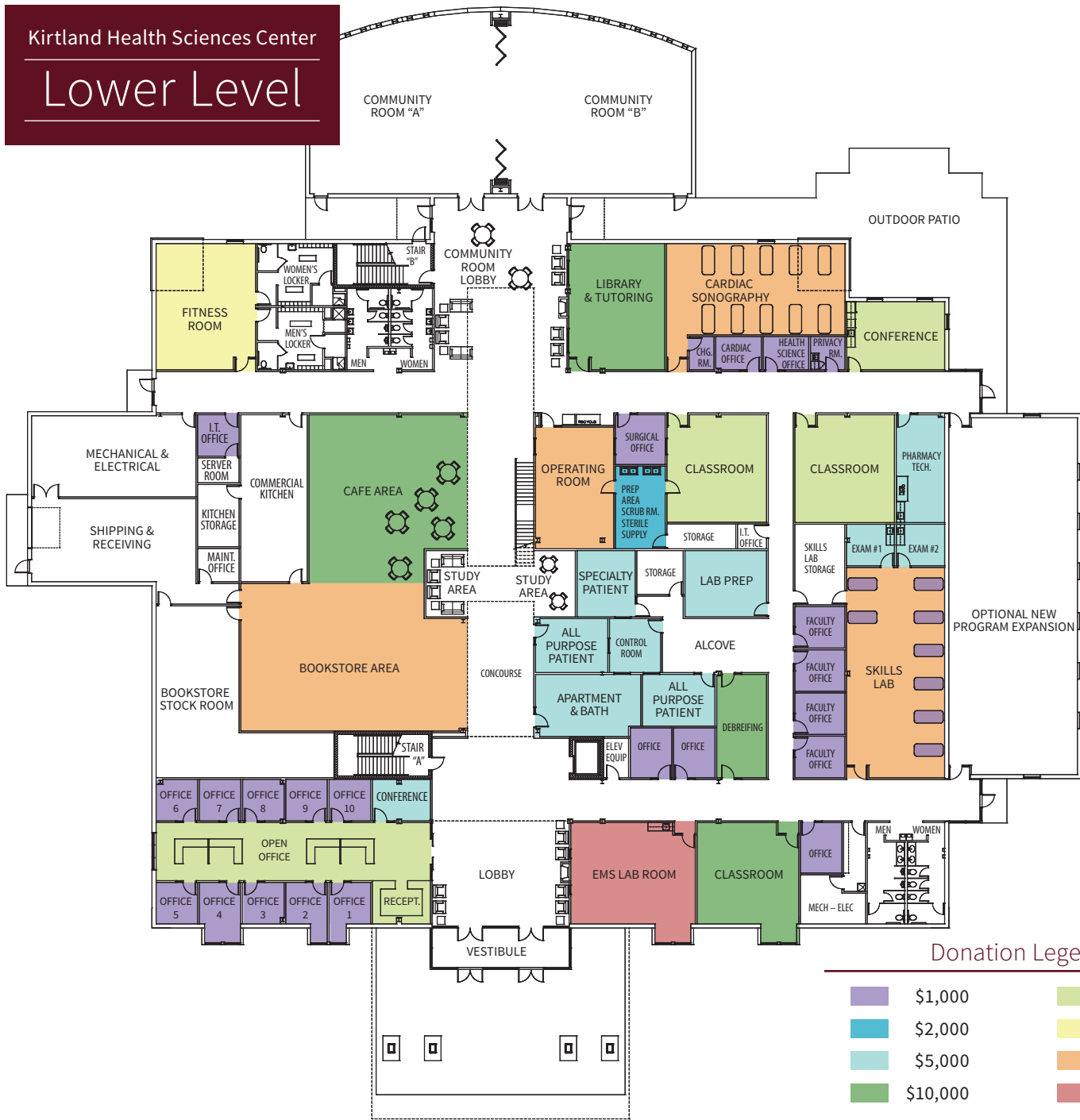

Donation Legend

Light Purple	\$1,000	Light Green	\$15,000
Light Blue	\$2,000	Light Yellow	\$20,000
Light Teal	\$5,000	Orange	\$50,000
Light Green	\$10,000	Red	\$100,000

Lower Level Entry Spaces

Bookstore	\$50,000
Cafe	\$10,000
Library & Tutoring Center	\$10,000
Student Services Conference Room	\$5,000
10 Student Services Offices	\$1,000 ea
Student Services Center	\$15,000
Fitness Center/Exercise Science	\$20,000

Lower Level Spaces | Health Sciences

Surgical Technology Operating Room	\$50,000	SIM Area Lab Prep	\$5,000
Surgical Technology Classroom	\$15,000	Simulated Apartment & Bath	\$5,000
Surgical Technology Scrub Room	\$2,000	9 Nursing Beds	\$1,000 ea
Surgical Technology Office	\$1,000	Nursing Skills Exam Room 1	\$5,000
Cardiac Sonography Laboratory	\$50,000	Nursing Skills Exam Room 2	\$5,000
Cardiac Sonography Office	\$1,000	Nursing Classroom	\$10,000
2 All-Purpose Patient Rooms	\$5,000 ea	Conference Room	\$15,000
Nursing Specialty Patient Room	\$5,000	I.T. Office	\$1,000
Nursing Debriefing Classroom	\$15,000	7 Faculty Offices	\$1,000 ea
Nursing Simulation Control Room	\$5,000	EMS classroom	\$10,000
Pharmacy Tech/Phlebotomy Classroom	\$5,000	EMS Office	\$1,000
Nursing Skills Lab	\$50,000	Privacy Room/Maternal Care	\$1,000

Partnering with Kirtland

Tom Quinn, President
(989) 275-5000 EXT 221

Investing in the Future

Lynne Ruden, Executive Director Kirtland Foundation
(989) 275-5000 EXT 446

Upper Level

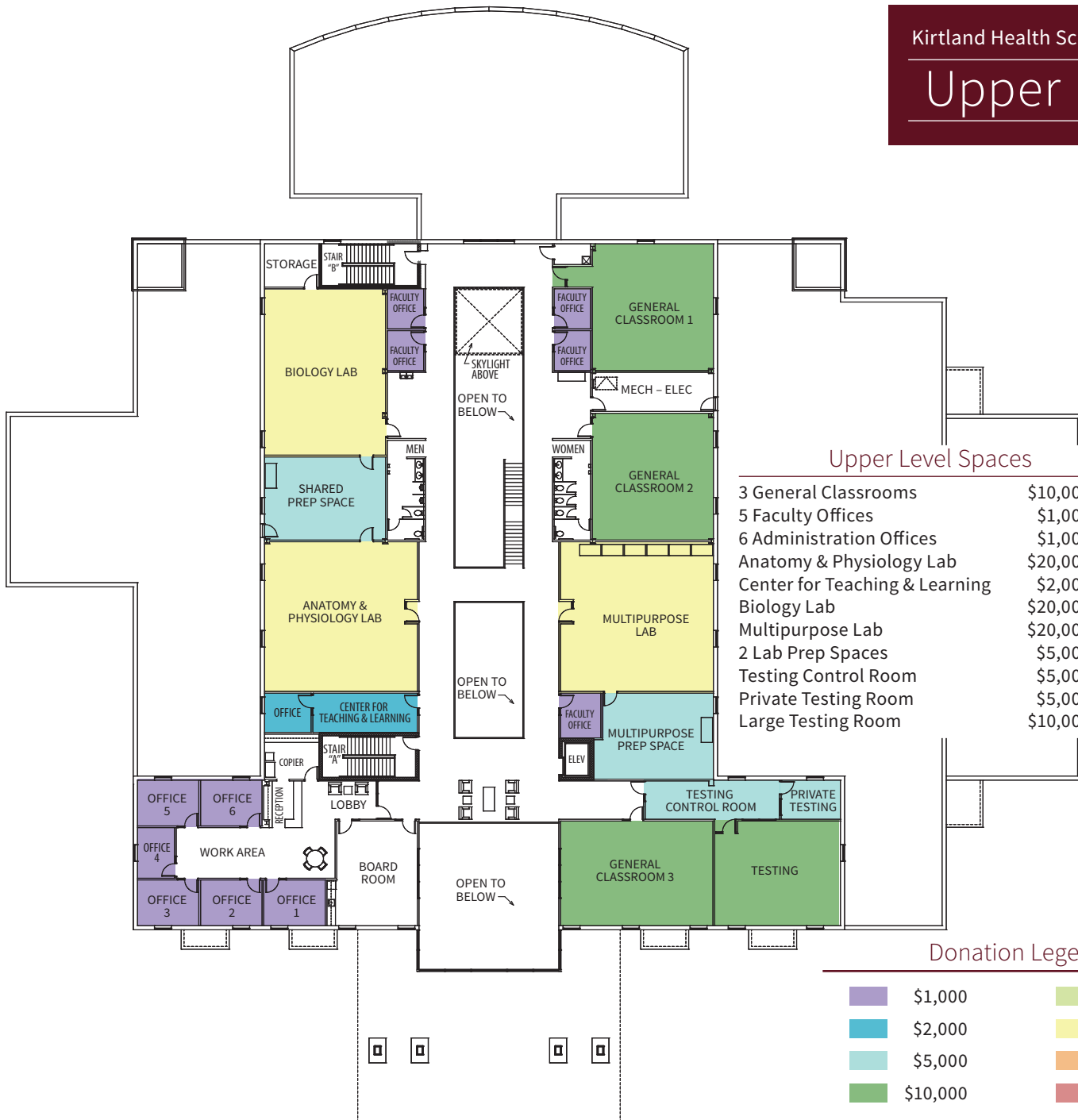

Upper Level Spaces

3 General Classrooms	\$10,000 ea
5 Faculty Offices	\$1,000 ea
6 Administration Offices	\$1,000 ea
Anatomy & Physiology Lab	\$20,000
Center for Teaching & Learning	\$2,000
Biology Lab	\$20,000
Multipurpose Lab	\$20,000
2 Lab Prep Spaces	\$5,000 ea
Testing Control Room	\$5,000
Private Testing Room	\$5,000
Large Testing Room	\$10,000

Donation Legend

 \$1,000	 \$15,000
 \$2,000	 \$20,000
 \$5,000	 \$50,000
 \$10,000	 \$100,000

Additional Naming Opportunities

Beyond naming traditional classrooms, there are many opportunities that are not represented on the floor plans. The following is a sampling of other ways to support this project.

Health Sciences Education & Training Center		Grounds & Landscape Features		Roscommon Campus Remodeling	
Entire Building	\$1.5 Million	Outdoor Recreational Fields	\$25,000	Auto Technology Classroom	\$5,000
Lobby & Vestibule	\$300,000	Environmental Gardens	\$25,000	Auto Technology Shop	\$15,000
Community Conference Center	\$250,000	Flag Pole & Reflection Area	\$10,000	Criminal Justice	
Health Sciences Wing	\$200,000	Bicycle Trail	\$10,000	Physical Training Room	\$5,000
Emergency Medical Program Lab	\$100,000	Art Gallery Wall	\$10,000	Criminal Justice	
Nursing Simulation Center	\$75,000	Each Reflection Area Bench	\$1,000 ea	Shooting Simulator Room	\$10,000
2 nd Floor Administration Board Room	\$14,000	500 Single Paver Bricks		Graphic Design Art Gallery	\$5,000
		Around the Flag Pole & Entry	\$200 ea	Graphic Design Classroom	\$5,000
		500 Double Paver Bricks		Graphic Design Lab	\$5,000
		Around the Flag Pole & Entry	\$400 ea	Composite Technologies Lab	\$10,000